

## **Anlage 3**

**schematische Darstellung der  
möglichen Bebauung**

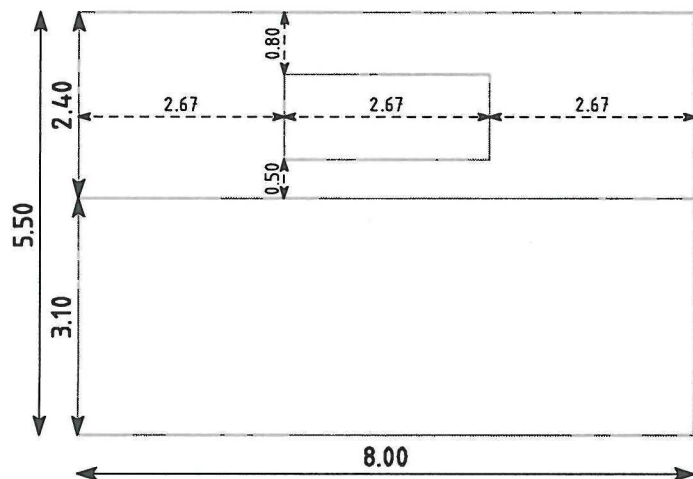

arno mill  
ingenieure

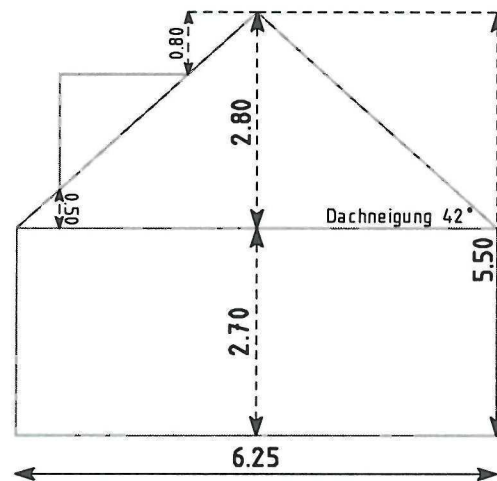
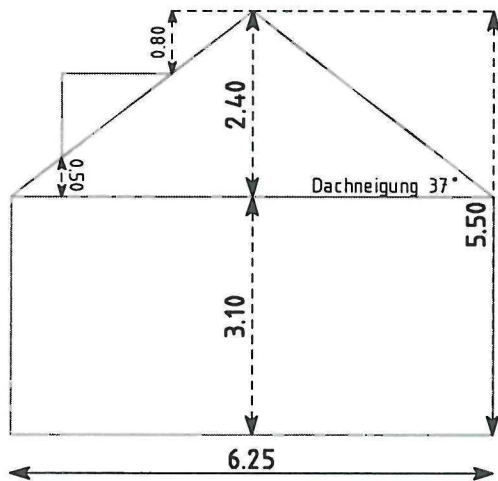

DIPL.-ING. (FH) ARNO MILL BAULEITPLANUNG  
MÖLLN MEDOW Nr. 6 18528 SEHLEN  
TEL 0 38 38 - 24 1 37 FAX 0 38 38 - 25 05 58

BP Nr. 14 „Erholungsgebiet Kreptitzer Heide“

Skizze mögliche Bebauung

Maßstab: 1: 100  
Stand: 13.03.2012